

- Bi-directional AC motor
- Apply to valves size of DN15 to DN32
- Fire retardant engineering plastic, measure up UL94V-0 standard
- High IP grade features (IP65)
- Quick and easy replacement of moving actuator
- High Differential pressure up to 1MPa and strict closure
- 100,000 working times life



Usage

SMBV06 Series ball valves are widely used in air conditioning fans, heating, and cooling caps. SMBV06 accurately controls room temperature by controlling hot and cold-water measurements as desired, preventing sudden changes in room temperature.

Technical Specifications

Environment	Hot/cold water or 60% glycol
Valve Diameter	DN15 DN20 D N25 DN32
Valve Type	2-Way- 3-Way
Working mode	On/Off, Floating Control
Operating Voltage	24-220 VAC
Power Consumption	6W (When changing valve position)
Operation Time	15 sec
Pipe Connection	BSP Internal Gear BSP External Gear (Optional)
Ambient temperature	2-55°C
Storage and Transport Temperature	-20-65°C

Material Properties

Body	Forged Brass
Ball	Stainless steel
Mil	Brass
Flap	Fiberglass reinforced with Teflon PTFE
Gasket	2 EPDM O-rings, lubricated
Pressure Strength	2MPa
Valve Operating Temperature Range	2-90°C
Maximum Pressure Difference	1MPa
Protection Class	IP65

Models

SM-BV06 Valve Actuators



Model	Power Supply	Control	Cable Length	Operation Time	Feedback
SM-BV06-24-F-150	24V AC	On/Off	150 mm	15 sec	Var
SM-BV06-220-F-150	220V AC	On/Off	150 mm	15 sec	Var

SM-G2 Valve Bodies

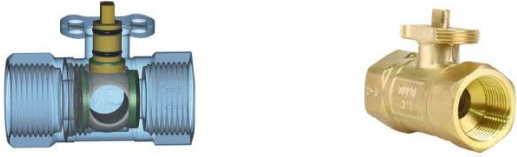

Model	Diameter	Way	Rated Pressure	KV Value	Internal-External Gear
SM-G2-D15SA	DN15	2 Way	PN20	4,62	Internal Gear
SM-G2-D20SA	DN20	2 Way	PN20	7,5	Internal Gear
SM-G2-D25SA	DN25	2 Way	PN20	13,02	Internal Gear
SM-G2-D32SA	DN32	2 Way	PN20	25,97	Internal Gear
SM-G2-D15SB	DN15	2 Way	PN20	4,62	External Gear
SM-G2-D20SB	DN20	2 Way	PN20	7,5	External Gear
SM-G2-D25SB	DN25	2 Way	PN20	13,02	External Gear
SM-G2-D32SB	DN32	2 Way	PN20	25,97	External Gear

SM-G3 Horizontal Outlet Valve Bodies



Model	Diameter	Way	Rated Pressure	KV Value	Internal-External Gear
SM-G3-AD15SA	DN15	3-Way- Horizontal Output	PN20	4,62	Internal Gear
SM-G3-AD20SA	DN20	3-Way- Horizontal Output	PN20	7,5	Internal Gear
SM-G3-AD25SA	DN25	3-Way- Horizontal Output	PN20	13,02	Internal Gear
SM-G3-AD32SA	DN32	3-Way- Horizontal Output	PN20	25,97	Internal Gear
SM-G3-AD15SB	DN15	3-Way- Horizontal Output	PN20	4,62	External Gear
SM-G3-AD20SB	DN20	3-Way- Horizontal Output	PN20	7,5	External Gear
SM-G3-AD25SB	DN25	3-Way- Horizontal Output	PN20	13,02	External Gear
SM-G3-AD32SB	DN32	3-Way- Horizontal Output	PN20	25,97	External Gear

Valve Body Installation

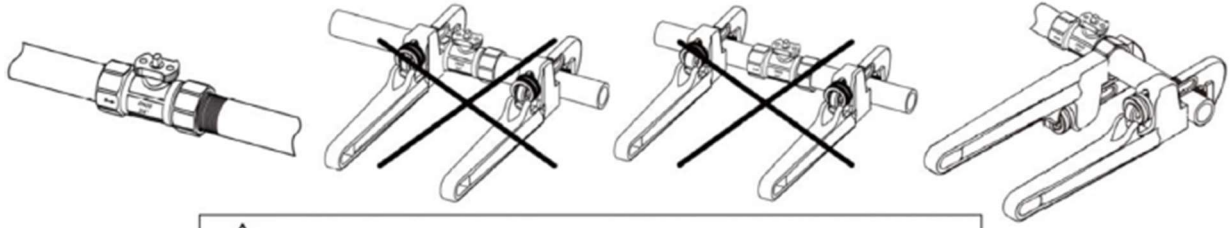

 Two pipe wrenched must put on the same side of Valve Stem and one of them must lock the valve connection to prevent the valve from turning.

Actuator Installation

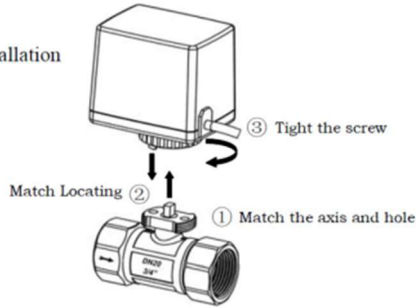

Use wrench to open or close the valve

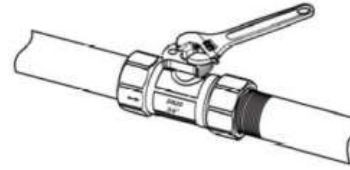

Actuator Dismantlement

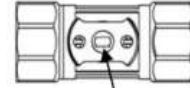
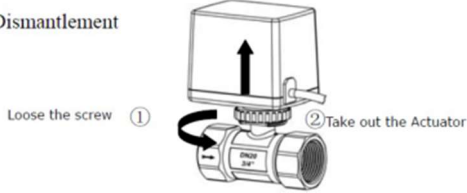

The horizonta stem means valve close

Wiring Diagram

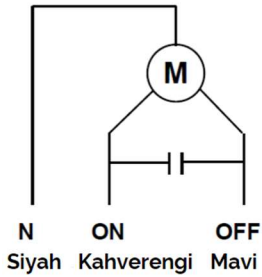

On/Off Kontrol

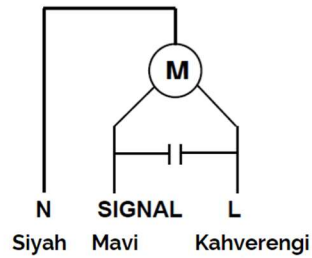

Yüzer Kontrol

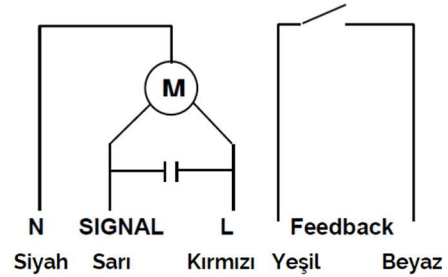

Yüzer Kontrol+ Feedback Bilgisi

Dimensions

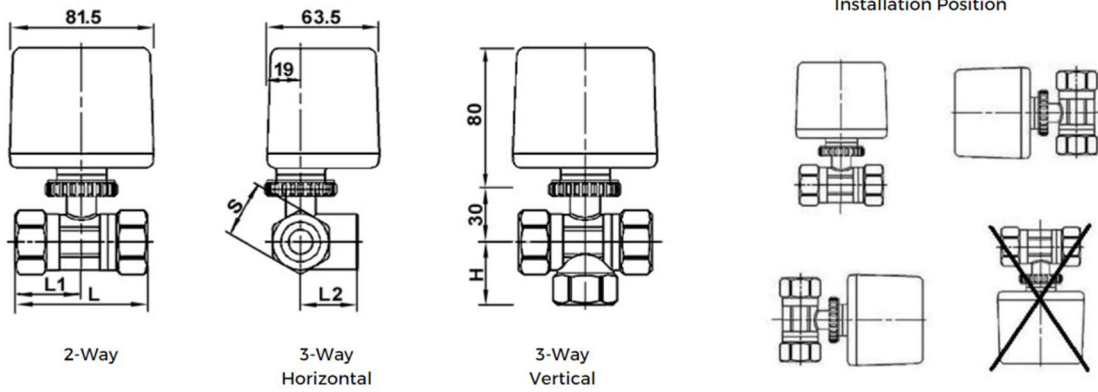

Caliber Inch (mm)	KV Value	L	L1	L2	H	S
1/2" (DN15)	4,62	67	33,5	34	34	27
3/4" (DN20)	7,50	66	33	36	36	32,5
1" (DN25)	13,02	88	44	38	40	40
1 1/4" (DN 32)	25,97	100	50	-	-	48